

KIDZ



www.texaskidz.com

ADVOCATES FOR KIDZ AND FAMILIES WITH SPECIAL NEEDS

Volume 2, Issue 3

May/June 2005

Monthly Meeting Info

March 2005 Summary:

Dr. Dana Rice spoke about Joni and Friends summer retreat. This camp has two sessions during the summer and allows families with a child with disabilities to attend as a unit and participate in various activities. The organization also has scholarships available to assist with the expenses.

April 2005 Summary:

Jay Dean, candidate for Mayor, and John Bolster, candidate for City Council District 5, were present. Patsy Williams from East Texas Angel Network, and Sue Haywood, a local physical therapist, were also there supporting our drive to implement playground equipment to be located within the new recreational facility being built in the Spring Hill area. This equipment would allow children with disabilities as well as children with no limitations to play together. We encourage everyone to contact their local City Council person and let them know you support this effort!

Upcoming Meetings:

Speakers in the following months will be: Attorney Mark Boon (living wills) and Janet White (siblings point of view). You don't want to miss out on these!

KIDZ MONTHLY MEETINGS

PLACE: NEW BEGINNINGS BAPTIST CHURCH
600 GEORGE RICHEY RD.
LONGVIEW, TX
(SEE MAP)

TIME: 2ND TUESDAY OF EACH MONTH
FROM 6:30 PM TO 8:00 PM

Childcare is available at no charge.

About Us...

KIDZ is a group of parents with special needs children who have joined together to provide support and information for other parents with special needs children regardless of how minor or severe the disability.

- Monthly Meetings
- Bi-monthly Newsletters
- First Contact Brochures
- Support Line (Connecting Parents to Parents)
- Special Events

Visit us on the web at www.texaskidz.com or call or write for more information about KIDZ and our programs. KIDZ mailing address and phone number can be found on the last page of this newsletter. ■

Family Focus

This column highlights stories from different families.

By Terry & Denise Bolton

In light of the recent tragedy where the mother severed the arms of her child, I would like to bring attention to mental illness.

Unfortunately, I am not new to this devastating illness. My own father committed suicide when I was only 6 yrs. old because he was never treated correctly for his disorder. My sister, niece, and most recently, my 14 yr. old son have all been diagnosed with Bi-Polar Disorder. It is a biological brain disorder, due to an imbalance in the chemical neurotransmitters of the brain. It affects the way a person acts, thinks, behaves, and learns. It also causes severe fluctuations in their moods and energy. A correct diagnoses and proper treatment are imperative in treating any form of mental illness.

There has always been such a stigma attached to

INSIDE THIS ISSUE

- | | |
|----------|-------------------------------|
| 1 | About Us... |
| 1 | Monthly Meeting Info |
| 1 | Family Focus |
| 2 | First Contact Brochure Update |
| 3 | News |
| 3 | Encouraging Words |

ADVERTISEMENT

FAMILY RESPITE
CARE, LLC

Non-Medical,
In-Home
Companion Care

- Housekeeping
- Pet Care
- Medication Reminders
- Meal Planning
- Meal Preparation
- Bill Reminders
- Errand Running
- Escort to Church/Social Events
- Other Services, as Need Determines

Respite (n.) a brief rest
from a difficult task

www.familyrespitecare.com
903-918-4727 (Phone)
903-452-4015 (Phone)
903-291-1913 (Fax)
E-mail: info@familyrespitecare.com

**First Contact
Brochure**

We have begun distributing our First Contact Brochures around town. Be on the lookout for them and be sure to spread the word about them. The response has been great so far with nearly 500 now being placed and requests for more!

One of the goals of this brochure is to inform new parents and existing parents that there are other families in our community with special needs children who are going through, have been through, or will go through the same challenges and uncertainties that they are facing.

Family Focus continued from page 1

mental illness that makes many people uncomfortable about sharing their problems. I, for one, am not embarrassed or ashamed to talk about it. I am teaching my son that he did not do anything to cause it, anymore than someone can cause cancer or diabetes. It is simply another organ that needs to be treated, and it happens to be mental instead of physical. He recently spent 8 days in Brentwood

“There has always been such a stigma attached to mental illness that makes many people uncomfortable about sharing their problems.”

Hospital in Shreveport to help get him stabilized, and to help him deal with being Bi-Polar. It helped him tremendously, even though it was the hardest decision his father and I have ever had to make.

People just need to educate themselves about mental illness, and learn how to deal with people in a compassionate way. They need love and understanding to cope with such a bizarre, scary, unpredictable, and devastating illness. When a person is out of touch with reality, he/she perceives their world to be so real to them, that they are capable of some of the most horrendous acts possible, such as the 3 women who killed their own children.

We, as a society, need to accept them and fight for them, when they aren't able to do so for themselves. We need to get them the help they so desperately need. Most people respond very well to treatment, although it may take awhile to find the right combination of medicines to treat them. Please don't be so quick to judge them and call them 'crazy.' We need to embrace them and start talking about mental illness before anymore innocent lives are lost. Learn more about mental illnesses at these websites:

- www.bpkids.org
- www.nami.org
- www.bipolarchild.com

“People just need to educate themselves about mental illness, and learn how to deal with people in a compassionate way.”

And please remember to pray for these people and their families who have been diagnosed with mood disorders. You would not believe how hard it is to deal with, and how much it affects the whole family. If it were not for our strong faith in God, and the loving support of our family, friends, and church, we would not be so fortunate today. God didn't curse our family with mental illness. He allowed it to bring us closer to Him, and to help make other people more aware of this illness. We give all the praise to Jesus Christ, our Lord and Savior, for bringing us through this valley. ■



- **KIDZ** has a website! You can view our newsletters, current and past issues, along with many other interesting things at www.texaskidz.com.
- We need your help! One of our goals is to have a “library” of information pertaining to different diseases, afflictions, or disabilities that you have dealt with. We would like to make this information available to others who are faced with the same situation for the first time. Please ensure that all the information you submit is 100% accurate. Send articles or references to info@texaskidz.com or mail copies to KIDZ, PO Box 10015, Longview, TX 75608-0015.
- If you are interested in purchasing advertising space in our newsletters, please e-mail us at info@texaskidz.com. Ads will be restricted to a limited number per issue and will be accepted/denied and placed at our discretion.
- **KIDZ** is working on getting universally accessible playground equipment placed in the Longview area. If you are interested in helping with this effort, which will benefit your children and the entire community by allowing all children to play together in one place, please contact us!



Handicap Accessible Children's Park
Lubbock, TX

Encouraging Words

“Life is a series of experiences, each one of which makes us bigger, even though it is hard to realize this. For the world was built to develop character, and we must learn that the setbacks and grieves which we endure help us in marching onward.”

- Henry Ford

If you would like to be on the mailing list to receive our KIDZ newsletter, please call Amber at (903) 663-5936 or e-mail us at info@texaskidz.com

FAST FACTS

“It is suspected that a significant number of children diagnosed in the United States with attention-deficit disorder with hyperactivity (ADHD) have early-onset bipolar disorder instead of, or along with, ADHD.”

“Depression in children and teens is usually chronic and relapsing. According to several studies, a significant proportion of the 3.4 million children and adolescents with depression in the United States may actually be experiencing the early onset of bipolar disorder, but have not yet experienced the manic phase of the illness.”

“Parents who suspect that their child has bipolar disorder (or any psychiatric illness) should take daily notes of their child's mood, behavior, sleep patterns, unusual events, and statements by the child of concern to the parents. Share these notes with the doctor making the evaluation and with the doctor who eventually treats your child.”

CABF Learning Center. Retrieved Apr. 27, 2005, from <http://www.bpkids.com/learning/about.htm>



KIDZ would like to say a special “thanks” to ...

Dana Rice, Jay Dean, John Bolster, Patsy Williams, Sue Haywood, & Kay Driggers.

All of those **volunteering** to watch the kids during our meetings!

Early Childhood Intervention (ECI) for providing copying and mailing services for our newsletters!

KIDZ MONTHLY MEETING

PLACE: NEW BEGINNINGS BAPTIST CHURCH
600 GEORGE RICHEY RD.
LONGVIEW, TX
(SEE MAP)

TIME: 2ND TUESDAY OF EACH MONTH
FROM 7:00 PM TO 8:30 PM

Childcare is available at no charge.



If you would like to make a donation to KIDZ, please make checks payable to:

NBBC c/o KIDZ

Donations are tax deductible.

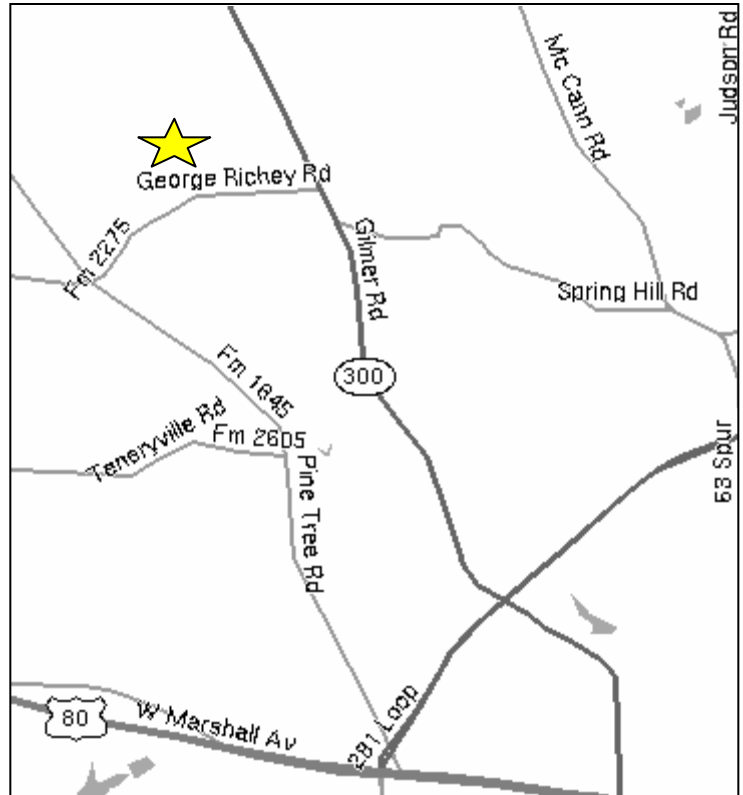

KIDZ is a bimonthly publication. As the KIDZ fiscal sponsor, New Beginnings Baptist Church oversees donations and disbursements on behalf of KIDZ in order for KIDZ to direct its efforts to the families in need.

KIDZ
P.O. Box 10015
Longview, TX 75608-0015

PLACE
PROPER
POSTAGE
HERE

ADDRESS CORRECTION REQUESTED

KIDZ
*ADVOCATES FOR KIDZ AND
FAMILIES WITH SPECIAL NEEDS*

(903) 663-5936
info@texaskidz.com